

# KOHLTECH

Solutions For Every Industry & Every Build

## LED Safety Spotter Series

The Sequential Safety Spot Light projects highly visible blinking spots on the ground to alert operators and workers of the direction of moving equipment in congested or low-light work areas.

### LED Sequential Spot Light

1. Safety spot light for all work vehicles & equipment
2. Higher light efficiency, lower light decay
3. 10~80V Wide Voltage range, suitable for various types equipment
4. Durable PC lens minimizes environmental damage
5. AL Die-Cast housing allows effective heat dissipation and extends lifespan
6. IP67 water and dust proof

### Specs

- Voltage: 10-80v DC
- Wattage: 12W
- LED: 4\*3W
- Function: Safety line
- Material: Aluminum
- Lens: PC
- Mount: bolt + nut
- Waterproof: IP67
- Operating temperature: -40° F / + 149° F
- Cable: 1'
- Weight: 1.4lbs
- 2 year warranty



Standard color:

Amber

Optional Colors:

Blue

Red

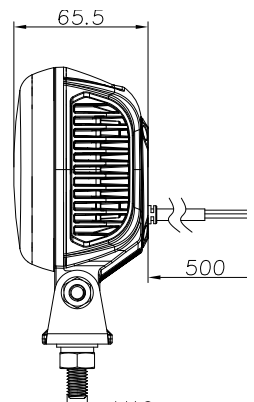
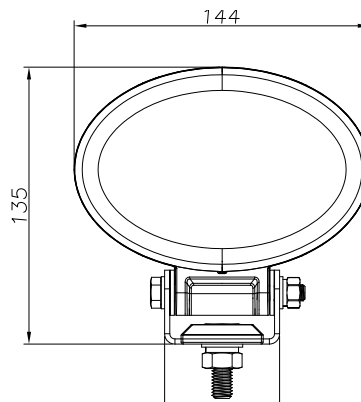
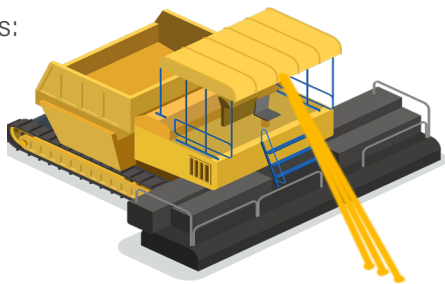

Have any questions or need additional information? | Call us today at 877.708.7803

KOHLTECH | [www.kohltechnology.com](http://www.kohltechnology.com) | [info@kohltechnology.com](mailto:info@kohltechnology.com)